

Owing to the destruction of the original Kirk Gresley Bogie tool whilst in Somerset, we have replaced the bogies in this kit with this **Micro Mold** Gresley Bogie and a modified bearing plate to suit the Kirk floors.

This bogie is designed so that it can either be glued together, using a solvent weld, or bolted together using 14BA (or M1) nuts and bolts (not supplied).

- |    |  |     |                                |
|----|--|-----|--------------------------------|
| 1. | <b>Bogie Sideframes x 2</b>                          | 7.  | <b>Axlebox Covers x 4 + 1</b>  |
| 2. | <b>Bearings -Turned Brass x 4 -<br/>NOT SUPPLIED</b> | 8.  | <b>Long Stepboards x 2</b>     |
| 3. | <b>Centre Moulding x 2</b>                           | 9.  | <b>Short Stepboards, x 4</b>   |
| 4. | <b>Stretchers NOT REQUIRED</b>                       | 10. | <b>Fixing Pin NOT REQUIRED</b> |
| 5. | <b>Bearing Plate - NOT REQUIRED</b>                  | 11. | <b>Coupling Bar</b>            |
| 6. | <b>Brake Shoes x 8 + 4</b>                           | 12. | <b>NEM Pocket</b>              |

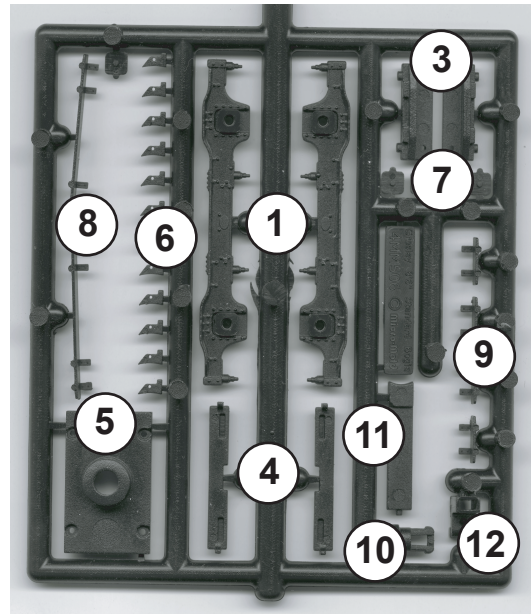

Fit the bearing cups (the bearings and 14 mm plain disc coach wheels are not supplied with this kit) with a dab of impact type adhesive.

Glue the Centre Mouldings into the Bogie Sideframes. The centre mouldings are a tight fit and will require a reasonable amount of force to ensure that they sit correctly.

Allow to dry.

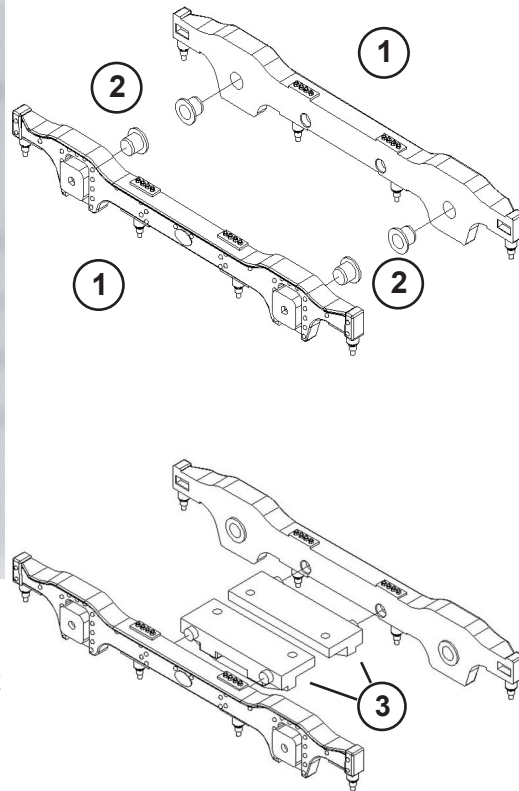

Take the Bearing Plate and push onto the Centre Moulding and side frames as shown. This can either be glued or screwed into place using M1 (14BA) screws (not supplied). Fit the wheelsets and then fit the second Bogie Sideframe in place. This bogie is supplied with separate brake shoes, stepboards and axlebox covers. The fitting of the brake shoes and stepboards is up to you, however, the axlebox covers should be fitted noting the handing on the drawing below. If required, glue the Coupling Bar and NEM pocket into place. Some modification may be required.

The Fixing Pin (part 10) is not used, instead a screw is provided. The screw goes through the hole in the bogie into the coach floor. In order to avoid splitting the coach floor open the hole up to 2.20mm { No. 44} [3/32"].

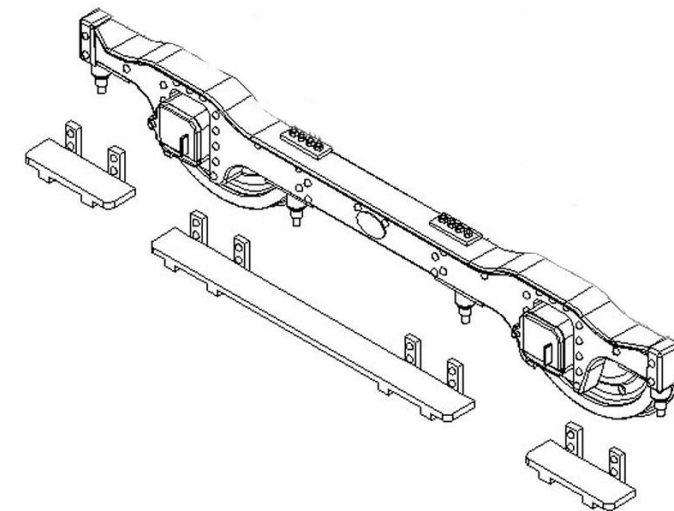
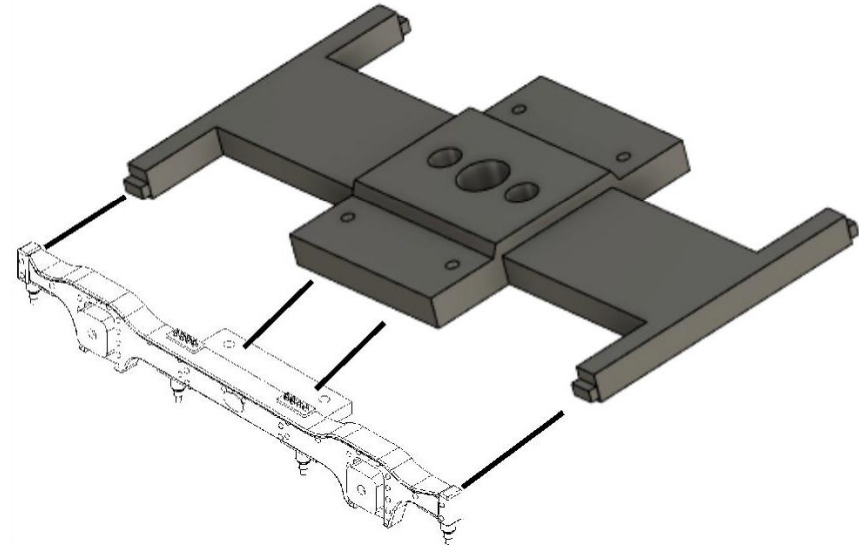

**Brake Shoes**

